

# Striking Face 6 Point Box Wrenches 12 Point Box Wrenches

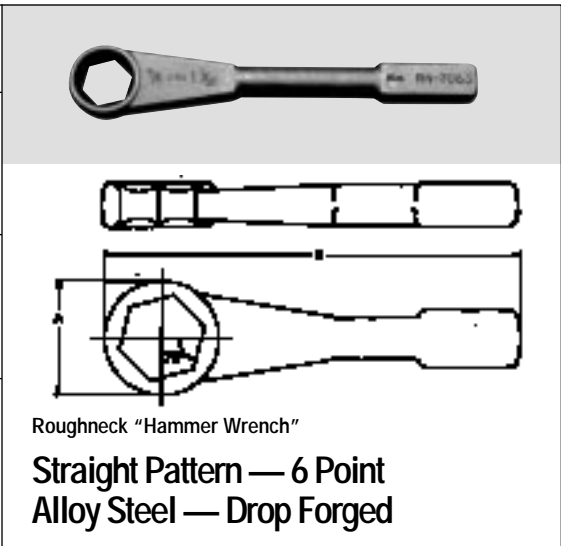

Wrench Opening (Nut Size)	Stud Size	Diameter of Head		Length	Wt. Ea. Lbs.	Industrial Black	Std. Pkg. Qty.	Wrench Opening (Nut Size)
		A	B			Part No.		
1 <sup>1</sup> / <sub>16</sub>	5/8	1 <sup>25</sup> / <sub>32</sub>	9 <sup>7</sup> / <sub>16</sub>	1.9		RN7063	1	1 <sup>1</sup> / <sub>16</sub>
1 <sup>1</sup> / <sub>4</sub>	3/4	2	10 <sup>1</sup> / <sub>4</sub>	2.1		RN7075	1	1 <sup>1</sup> / <sub>4</sub>
1 <sup>1</sup> / <sub>2</sub>	7/8	2 <sup>17</sup> / <sub>64</sub>	10 <sup>5</sup> / <sub>16</sub>	2.6		RN7088	1	1 <sup>1</sup> / <sub>2</sub>
1 <sup>3</sup> / <sub>8</sub>	1	2 <sup>31</sup> / <sub>64</sub>	11	2.9		RN7100	1	1 <sup>3</sup> / <sub>8</sub>
1 <sup>1</sup> / <sub>2</sub>	1 <sup>1</sup> / <sub>8</sub>	2 <sup>21</sup> / <sub>32</sub>	11 <sup>1</sup> / <sub>16</sub>	3.5		RN7113	1	1 <sup>1</sup> / <sub>2</sub>
2	1 <sup>1</sup> / <sub>4</sub>	3 <sup>1</sup> / <sub>32</sub>	11 <sup>1</sup> / <sub>16</sub>	4.0		RN7125	1	2
2 <sup>1</sup> / <sub>16</sub>	1 <sup>1</sup> / <sub>8</sub>	3 <sup>1</sup> / <sub>32</sub>	12	5.2		RN7138	1	2 <sup>1</sup> / <sub>16</sub>
2 <sup>1</sup> / <sub>8</sub>	1 <sup>1</sup> / <sub>2</sub>	3 <sup>13</sup> / <sub>32</sub>	12 <sup>3</sup> / <sub>8</sub>	6.0		RN7150	1	2 <sup>1</sup> / <sub>8</sub>
2 <sup>1</sup> / <sub>4</sub>	1 <sup>3</sup> / <sub>8</sub>	3 <sup>3</sup> / <sub>4</sub>	12 <sup>1</sup> / <sub>16</sub>	6.6		RN7163	1	2 <sup>1</sup> / <sub>4</sub>
2 <sup>3</sup> / <sub>8</sub>	1 <sup>1</sup> / <sub>2</sub>	4 <sup>1</sup> / <sub>64</sub>	13 <sup>3</sup> / <sub>8</sub>	7.5		RN7175	1	2 <sup>3</sup> / <sub>8</sub>
2 <sup>1</sup> / <sub>2</sub>	1 <sup>3</sup> / <sub>8</sub>	4 <sup>23</sup> / <sub>64</sub>	13 <sup>1</sup> / <sub>16</sub>	7.9		RN7188	1	2 <sup>1</sup> / <sub>2</sub>
3 <sup>1</sup> / <sub>8</sub>	2	4 <sup>31</sup> / <sub>64</sub>	13 <sup>3</sup> / <sub>16</sub>	9.4		RN7200	1	3 <sup>1</sup> / <sub>8</sub>
3 <sup>1</sup> / <sub>4</sub>	2 <sup>1</sup> / <sub>4</sub>	4 <sup>31</sup> / <sub>32</sub>	14 <sup>1</sup> / <sub>8</sub>	10.5		RN7225	1	3 <sup>1</sup> / <sub>4</sub>
3 <sup>3</sup> / <sub>8</sub>	2 <sup>1</sup> / <sub>2</sub>	5 <sup>35</sup> / <sub>64</sub>	14 <sup>1</sup> / <sub>2</sub>	13.3		RN7250	1	3 <sup>3</sup> / <sub>8</sub>



Wrench Opening (Nut Size)	Stud Size	Diameter of Head		Length	Wt. Ea. Lbs.	Industrial Black	Std. Pkg. Qty.	Wrench Opening (Nut Size)
		A	B			Part No.		
1 <sup>1</sup> / <sub>16</sub>	5/8	1 <sup>25</sup> / <sub>32</sub>	9 <sup>7</sup> / <sub>16</sub>	1.9		1807	1	1 <sup>1</sup> / <sub>16</sub>
1 <sup>1</sup> / <sub>4</sub>	3/4	2	10 <sup>1</sup> / <sub>4</sub>	2.1		1808B	1	1 <sup>1</sup> / <sub>4</sub>
1 <sup>1</sup> / <sub>2</sub>	7/8	2	10 <sup>1</sup> / <sub>4</sub>	2.1		1808	1	1 <sup>1</sup> / <sub>2</sub>
1 <sup>3</sup> / <sub>8</sub>	1	2	10 <sup>1</sup> / <sub>4</sub>	2.1		1808A	1	1 <sup>3</sup> / <sub>8</sub>
1 <sup>1</sup> / <sub>2</sub>	1 <sup>1</sup> / <sub>8</sub>	2 <sup>17</sup> / <sub>64</sub>	10 <sup>5</sup> / <sub>16</sub>	2.6		1809B	1	1 <sup>1</sup> / <sub>2</sub>
1 <sup>1</sup> / <sub>2</sub>	7/8	2 <sup>17</sup> / <sub>64</sub>	10 <sup>7</sup> / <sub>16</sub>	2.6		1809	1	1 <sup>1</sup> / <sub>2</sub>
1 <sup>1</sup> / <sub>2</sub>	7/8	2 <sup>17</sup> / <sub>64</sub>	10 <sup>7</sup> / <sub>16</sub>	2.6		1809A	1	1 <sup>1</sup> / <sub>2</sub>
1 <sup>3</sup> / <sub>8</sub>	1	2 <sup>31</sup> / <sub>64</sub>	11	2.9		1810	1	1 <sup>3</sup> / <sub>8</sub>
1 <sup>1</sup> / <sub>2</sub>	1	2 <sup>31</sup> / <sub>64</sub>	11	2.9		1810A	1	1 <sup>1</sup> / <sub>2</sub>
1 <sup>1</sup> / <sub>2</sub>	1 <sup>1</sup> / <sub>8</sub>	2 <sup>21</sup> / <sub>32</sub>	11 <sup>1</sup> / <sub>16</sub>	3.5		1811B	1	1 <sup>1</sup> / <sub>2</sub>
1 <sup>3</sup> / <sub>8</sub>	1 <sup>1</sup> / <sub>8</sub>	2 <sup>21</sup> / <sub>32</sub>	11 <sup>1</sup> / <sub>16</sub>	3.5		1811	1	1 <sup>3</sup> / <sub>8</sub>
1 <sup>1</sup> / <sub>2</sub>	1 <sup>1</sup> / <sub>8</sub>	2 <sup>21</sup> / <sub>32</sub>	11 <sup>1</sup> / <sub>16</sub>	3.5		1811A	1	1 <sup>1</sup> / <sub>2</sub>
2	1 <sup>1</sup> / <sub>4</sub>	3 <sup>1</sup> / <sub>32</sub>	11 <sup>1</sup> / <sub>16</sub>	4.0		1812	1	2
2 <sup>1</sup> / <sub>16</sub>	1 <sup>1</sup> / <sub>4</sub>	3 <sup>1</sup> / <sub>32</sub>	11 <sup>1</sup> / <sub>16</sub>	4.0		1812B	1	2 <sup>1</sup> / <sub>16</sub>
2 <sup>1</sup> / <sub>8</sub>	1 <sup>1</sup> / <sub>8</sub>	3 <sup>1</sup> / <sub>32</sub>	12	5.2		1813B	1	2 <sup>1</sup> / <sub>8</sub>
2 <sup>3</sup> / <sub>16</sub>	1 <sup>1</sup> / <sub>8</sub>	3 <sup>1</sup> / <sub>32</sub>	12	5.2		1813	1	2 <sup>3</sup> / <sub>16</sub>
2 <sup>1</sup> / <sub>4</sub>	1 <sup>1</sup> / <sub>2</sub>	3 <sup>13</sup> / <sub>32</sub>	12 <sup>3</sup> / <sub>8</sub>	6.0		1813A	1	2 <sup>1</sup> / <sub>4</sub>
2 <sup>1</sup> / <sub>8</sub>	1 <sup>1</sup> / <sub>2</sub>	3 <sup>13</sup> / <sub>32</sub>	12 <sup>3</sup> / <sub>8</sub>	6.0		1814	1	2 <sup>1</sup> / <sub>8</sub>
2 <sup>1</sup> / <sub>16</sub>	1 <sup>3</sup> / <sub>8</sub>	3 <sup>3</sup> / <sub>4</sub>	12 <sup>1</sup> / <sub>16</sub>	6.6		1815	1	2 <sup>1</sup> / <sub>16</sub>
2 <sup>1</sup> / <sub>8</sub>	1 <sup>3</sup> / <sub>8</sub>	3 <sup>3</sup> / <sub>4</sub>	12 <sup>1</sup> / <sub>16</sub>	6.6		1815A	1	2 <sup>1</sup> / <sub>8</sub>
2 <sup>3</sup> / <sub>8</sub>	1 <sup>3</sup> / <sub>8</sub>	4 <sup>1</sup> / <sub>64</sub>	13 <sup>3</sup> / <sub>16</sub>	7.5		1816	1	2 <sup>3</sup> / <sub>8</sub>
2 <sup>1</sup> / <sub>2</sub>	1 <sup>3</sup> / <sub>8</sub>	4 <sup>23</sup> / <sub>64</sub>	13 <sup>1</sup> / <sub>16</sub>	7.9		1816B	1	2 <sup>1</sup> / <sub>2</sub>
3	2	4 <sup>31</sup> / <sub>64</sub>	13 <sup>3</sup> / <sub>16</sub>	9.4		1817A	1	3
3 <sup>1</sup> / <sub>8</sub>	2	4 <sup>31</sup> / <sub>64</sub>	13 <sup>3</sup> / <sub>16</sub>	9.4		1817	1	3 <sup>1</sup> / <sub>8</sub>
3 <sup>1</sup> / <sub>4</sub>	2 <sup>1</sup> / <sub>4</sub>	4 <sup>31</sup> / <sub>32</sub>	14 <sup>1</sup> / <sub>8</sub>	10.5		1818A	1	3 <sup>1</sup> / <sub>4</sub>
3 <sup>1</sup> / <sub>2</sub>	2 <sup>1</sup> / <sub>4</sub>	4 <sup>31</sup> / <sub>32</sub>	14 <sup>1</sup> / <sub>8</sub>	10.5		1818	1	3 <sup>1</sup> / <sub>2</sub>
3 <sup>3</sup> / <sub>8</sub>	2 <sup>1</sup> / <sub>2</sub>	5 <sup>25</sup> / <sub>64</sub>	14 <sup>1</sup> / <sub>2</sub>	13.3		1819B	1	3 <sup>3</sup> / <sub>8</sub>
3 <sup>1</sup> / <sub>2</sub>	2 <sup>1</sup> / <sub>2</sub>	5 <sup>25</sup> / <sub>64</sub>	14 <sup>1</sup> / <sub>2</sub>	13.3		1819	1	3 <sup>1</sup> / <sub>2</sub>
4 <sup>1</sup> / <sub>8</sub>	2 <sup>3</sup> / <sub>4</sub>	6 <sup>1</sup> / <sub>2</sub>	16	20.8		1820B	1	4 <sup>1</sup> / <sub>8</sub>
4 <sup>1</sup> / <sub>4</sub>	2 <sup>3</sup> / <sub>4</sub>	6 <sup>1</sup> / <sub>2</sub>	16	18		1820	1	4 <sup>1</sup> / <sub>4</sub>
4 <sup>1</sup> / <sub>2</sub>	3	7	17	26		1821B	1	4 <sup>1</sup> / <sub>2</sub>
4 <sup>3</sup> / <sub>8</sub>	3	7	17	25.2		1821	1	4 <sup>3</sup> / <sub>8</sub>

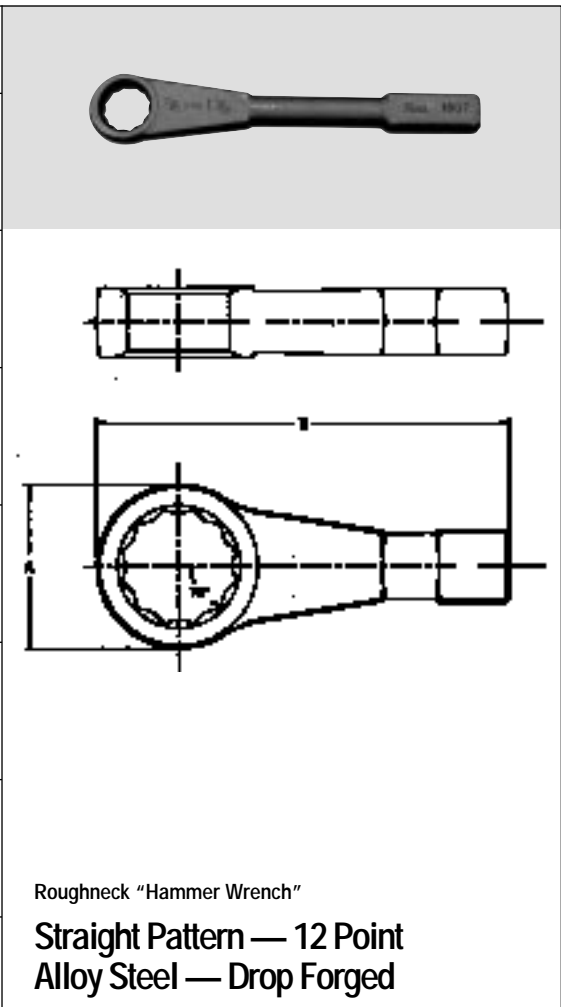

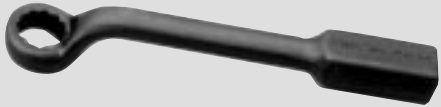
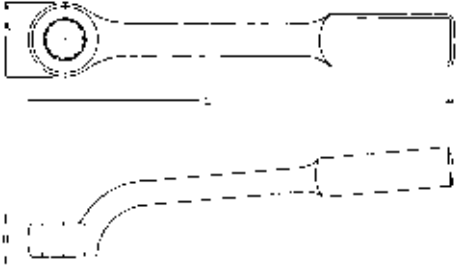

# Striking Face Box Wrenches

	Wrench Opening	Diameter of Head	Thickness of Head	Length	Wt. Ea. Lbs.	Industrial Black	Std. Pkg. Qty.	Wrench Opening
		A	B			Part No.		
	1 <sup>1</sup> / <sub>16</sub>	1 <sup>11</sup> / <sub>16</sub>	1 <sup>3</sup> / <sub>16</sub>	10 <sup>1</sup> / <sub>2</sub>	2.3	8807	1	1 <sup>1</sup> / <sub>16</sub>
	1 <sup>1</sup> / <sub>8</sub>	1 <sup>11</sup> / <sub>16</sub>	1 <sup>3</sup> / <sub>16</sub>	10 <sup>1</sup> / <sub>2</sub>	2.3	8807A	1	1 <sup>1</sup> / <sub>8</sub>
	1 <sup>1</sup> / <sub>4</sub>	2	7 <sup>7</sup> / <sub>16</sub>	11	3.1	8808	1	1 <sup>1</sup> / <sub>4</sub>
	1 <sup>3</sup> / <sub>8</sub>	2	7 <sup>7</sup> / <sub>16</sub>	11	3.0	8808A	1	1 <sup>3</sup> / <sub>8</sub>
	1 <sup>1</sup> / <sub>2</sub>	2 <sup>2</sup> / <sub>16</sub>	1	11 <sup>1</sup> / <sub>2</sub>	3.8	8809B	1	1 <sup>1</sup> / <sub>2</sub>
	1 <sup>7</sup> / <sub>16</sub>	2 <sup>2</sup> / <sub>16</sub>	1	11 <sup>1</sup> / <sub>2</sub>	3.8	8809	1	1 <sup>7</sup> / <sub>16</sub>
  45° Offset Pattern — 12 Point  <b>Black Industrial Finish Drop Forged</b>	1 <sup>1</sup> / <sub>2</sub>	2 <sup>2</sup> / <sub>16</sub>	1	11 <sup>1</sup> / <sub>2</sub>	3.8	8809A	1	1 <sup>1</sup> / <sub>2</sub>
	1 <sup>5</sup> / <sub>8</sub>	2 <sup>1</sup> / <sub>2</sub>	1 <sup>1</sup> / <sub>16</sub>	12	4.7	8810	1	1 <sup>5</sup> / <sub>8</sub>
	1 <sup>11</sup> / <sub>16</sub>	2 <sup>1</sup> / <sub>2</sub>	1 <sup>1</sup> / <sub>16</sub>	12	4.7	8810A	1	1 <sup>11</sup> / <sub>16</sub>
	1 <sup>3</sup> / <sub>4</sub>	2 <sup>1</sup> / <sub>8</sub>	1 <sup>1</sup> / <sub>8</sub>	12 <sup>1</sup> / <sub>2</sub>	5.9	8811B	1	1 <sup>3</sup> / <sub>4</sub>
	1 <sup>13</sup> / <sub>16</sub>	2 <sup>1</sup> / <sub>8</sub>	1 <sup>1</sup> / <sub>8</sub>	12 <sup>1</sup> / <sub>2</sub>	5.9	8811	1	1 <sup>13</sup> / <sub>16</sub>
	1 <sup>1</sup> / <sub>8</sub>	2 <sup>1</sup> / <sub>8</sub>	1 <sup>1</sup> / <sub>8</sub>	12 <sup>1</sup> / <sub>2</sub>	5.8	8811A	1	1 <sup>1</sup> / <sub>8</sub>
	1 <sup>15</sup> / <sub>16</sub>	3	1 <sup>1</sup> / <sub>4</sub>	13	6.3	8812A	1	1 <sup>15</sup> / <sub>16</sub>
	2	3	1 <sup>1</sup> / <sub>4</sub>	13	6.3	8812	1	2
	2 <sup>1</sup> / <sub>8</sub>	3 <sup>3</sup> / <sub>8</sub>	1 <sup>1</sup> / <sub>8</sub>	13 <sup>1</sup> / <sub>2</sub>	7.7	8813B	1	2 <sup>1</sup> / <sub>8</sub>
	2 <sup>1</sup> / <sub>16</sub>	3 <sup>3</sup> / <sub>8</sub>	1 <sup>1</sup> / <sub>8</sub>	13 <sup>1</sup> / <sub>2</sub>	7.7	8813	1	2 <sup>1</sup> / <sub>16</sub>
	2 <sup>1</sup> / <sub>4</sub>	3 <sup>3</sup> / <sub>8</sub>	1 <sup>1</sup> / <sub>8</sub>	13 <sup>1</sup> / <sub>2</sub>	7.6	8813A	1	2 <sup>1</sup> / <sub>4</sub>
	2 <sup>5</sup> / <sub>16</sub>	3 <sup>23</sup> / <sub>32</sub>	1 <sup>1</sup> / <sub>2</sub>	14	8.8	8814A	1	2 <sup>5</sup> / <sub>16</sub>
	2 <sup>3</sup> / <sub>8</sub>	3 <sup>23</sup> / <sub>32</sub>	1 <sup>1</sup> / <sub>2</sub>	14	8.6	8814	1	2 <sup>3</sup> / <sub>8</sub>
	2 <sup>1</sup> / <sub>2</sub>	4 <sup>5</sup> / <sub>16</sub>	1 <sup>3</sup> / <sub>4</sub>	15 <sup>1</sup> / <sub>4</sub>	14.3	8815B	1	2 <sup>1</sup> / <sub>2</sub>
	2 <sup>1</sup> / <sub>16</sub>	4 <sup>5</sup> / <sub>16</sub>	1 <sup>3</sup> / <sub>4</sub>	15 <sup>1</sup> / <sub>4</sub>	14.1	8815	1	2 <sup>1</sup> / <sub>16</sub>
2 <sup>1</sup> / <sub>8</sub>	4 <sup>5</sup> / <sub>16</sub>	1 <sup>3</sup> / <sub>4</sub>	15 <sup>1</sup> / <sub>4</sub>	13.9	8815A	1	2 <sup>1</sup> / <sub>8</sub>	
2 <sup>1</sup> / <sub>4</sub>	4 <sup>5</sup> / <sub>16</sub>	1 <sup>3</sup> / <sub>4</sub>	15 <sup>1</sup> / <sub>4</sub>	13.6	8816	1	2 <sup>1</sup> / <sub>4</sub>	
2 <sup>15</sup> / <sub>16</sub>	4 <sup>13</sup> / <sub>16</sub>	2	16 <sup>1</sup> / <sub>2</sub>	18.6	8816B	1	2 <sup>15</sup> / <sub>16</sub>	
3	4 <sup>13</sup> / <sub>16</sub>	2	16 <sup>1</sup> / <sub>2</sub>	18.0	8817	1	3	
3 <sup>1</sup> / <sub>8</sub>	4 <sup>13</sup> / <sub>16</sub>	2	16 <sup>1</sup> / <sub>2</sub>	17.7	8817A	1	3 <sup>1</sup> / <sub>8</sub>	

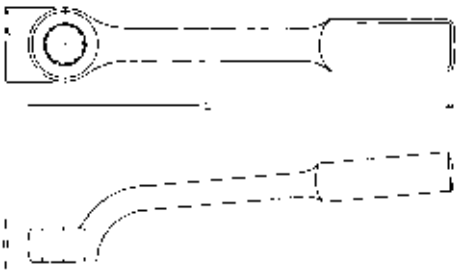
  45° Offset Pattern — 12 Point  <b>Black Industrial Finish Drop Forged</b>	Wrench Opening	Diameter of Head	Thickness of Head	Length	Wt. Ea. Lbs.	Industrial Black	Std. Pkg. Qty.	Wrench Opening
		A	B			Part No.		
	32 mm	2	7 <sup>7</sup> / <sub>16</sub>	11	3.1	8832 mm	1	32 mm
	36 mm	2 <sup>2</sup> / <sub>16</sub>	1	11 <sup>1</sup> / <sub>2</sub>	3.8	8836 mm	1	36 mm
	41 mm	2 <sup>1</sup> / <sub>2</sub>	1 <sup>1</sup> / <sub>16</sub>	12	4.7	8841 mm	1	41 mm
	46 mm	2 <sup>1</sup> / <sub>8</sub>	1 <sup>1</sup> / <sub>8</sub>	12 <sup>1</sup> / <sub>2</sub>	5.9	8846 mm	1	46 mm
	50 mm	3	1 <sup>1</sup> / <sub>4</sub>	13	6.3	8850 mm	1	50 mm
	55 mm	3 <sup>3</sup> / <sub>8</sub>	1 <sup>1</sup> / <sub>8</sub>	13 <sup>1</sup> / <sub>2</sub>	7.7	8855 mm	1	55 mm
	60 mm	3 <sup>23</sup> / <sub>32</sub>	1 <sup>1</sup> / <sub>2</sub>	14	8.6	8860 mm	1	60 mm
	65 mm	4 <sup>5</sup> / <sub>16</sub>	1 <sup>3</sup> / <sub>4</sub>	15 <sup>1</sup> / <sub>4</sub>	14.4	8865 mm	1	65 mm
	70 mm	4 <sup>5</sup> / <sub>16</sub>	1 <sup>3</sup> / <sub>4</sub>	15 <sup>1</sup> / <sub>4</sub>	13.6	8870 mm	1	70 mm
	75 mm	4 <sup>13</sup> / <sub>16</sub>	2	16 <sup>1</sup> / <sub>2</sub>	18.6	8875 mm	1	75 mm
	80 mm	4 <sup>13</sup> / <sub>16</sub>	2	16 <sup>1</sup> / <sub>2</sub>	17.7	8880 mm	1	80 mm